







LEGEND PROPOSED

-  STORMWATER PIPE
-  CHARGED LINE
-  GRATED PIT
-  DOWNPIPE
-  BOUNDARY LINE

NO OSD IS REQUIRED SINCE THIS IS A SINGLE DWELING WITH A COMBINED IMPREVIOUS AREA OF NO MORE THAN 75% OF THE SITE AREA,BASED ON BANKSTOWN COUNCIL DCP SECTION 4 PART 4.1.

NOTES:

- ALL WORK IS TO BE CARRIED OUT IN ACCORDANCE WITH CANTERBURY BANKSTOWN COUNCIL'S DCP, AS3500.3 STORMWATER DRAINAGE.
- THE CONTRACTOR IS TO LOCATE AND LEVEL ALL EXISTING SERVICES PRIOR TO THE COMMENCEMENT OF CONSTRUCTION, WHETHER INDICATED ON THE PLANS OR NOT, AND MAKE ARRANGEMENTS WITH THE RELEVANT AUTHORITY TO RELOCATE OR ADJUST IF NECESSARY. ANY DAMAGE TO EXISTING SERVICES SHALL BE RECTIFIED AT THE CONTRACTORS EXPENSE.
- THE CONTRACTOR IS NOT TO ENTER UPON NOR DO ANY WORK WITHIN ADJOINING LANDS WITHOUT THE PERMISSION OF THE SUPERINTENDENT.
- THE CONTRACTOR SHALL EFFECT TEMPORARY DRAINAGE MEASURES TO AVOID LOCALISED PONDING OF SURFACE RUN-OFF.
- ALL NEW WORKS TO MAKE SMOOTH CONNECTION TO EXISTING CONDITIONS.
- THE CONTRACTOR IS TO MAINTAIN SERVICES AND ALL WEATHER ACCESS AT ALL TIMES TO ADJOINING PROPERTIES.
- ALL DRAINAGE ELEMENTS ARE SHOWN DIAGRAMATICALLY BASED ON AVAILABLE DRAWINGS, TO BE INSTALLED WITH CONSIDERATION TO SITE CONSTRAINTS AND THE INTENT OF THE DRAINAGE CONCEPT.
- ALL DOWNPIPES ARE SHOWN DIAGRAMATICALLY, POSITIONS ARE TO BE CONFIRMED ON SITE USING THE WORKING DRAWINGS.
- THE CONTRACTOR IS TO LOCATE AND LEVEL ALL EXISTING DRAINAGE PITS AND PIPES PRIOR TO THE COMMENCEMENT OF CONSTRUCTION AND THE CONSTRUCTION IS TO COMMENCE FROM THE DOWNSTREAM PIT AND STRUCTURES.
- ALL DOWNPIPES ARE TO BE MINIMUM 90mm uPVC OR 100mm x 75mm U.N.O.
- ALL DOWNPIPES TO BE PROVIDED WITH CLEANING EYES.
- ALL STORMWATER PIPES ARE TO BE MINIMUM 100mm uPVC ON 1% MINIMUM GRADE U.N.O. AND TO HAVE MIN 100mm COVER.
- ALL GUTTERS TO BE INSTALLED WITH GUTTER GUARDS UNLESS NOTED OTHERWISE.
- ENSURE THAT ALL PITS AND PIPES ARE LOCATED CLEAR FROM ANY TREE ROOT SYSTEMS.
- ALL STORMWATER PITS TO BE LOCATED AT LOW POINTS TO PREVENT PONDED WATER.
- CHARGED DOWNPIPE LINES ARE TO BE 100MM SEWER GRADE UPVC AND SEALED FROM 300MM BELOW THE TOP OF THE DOWNPIPE.

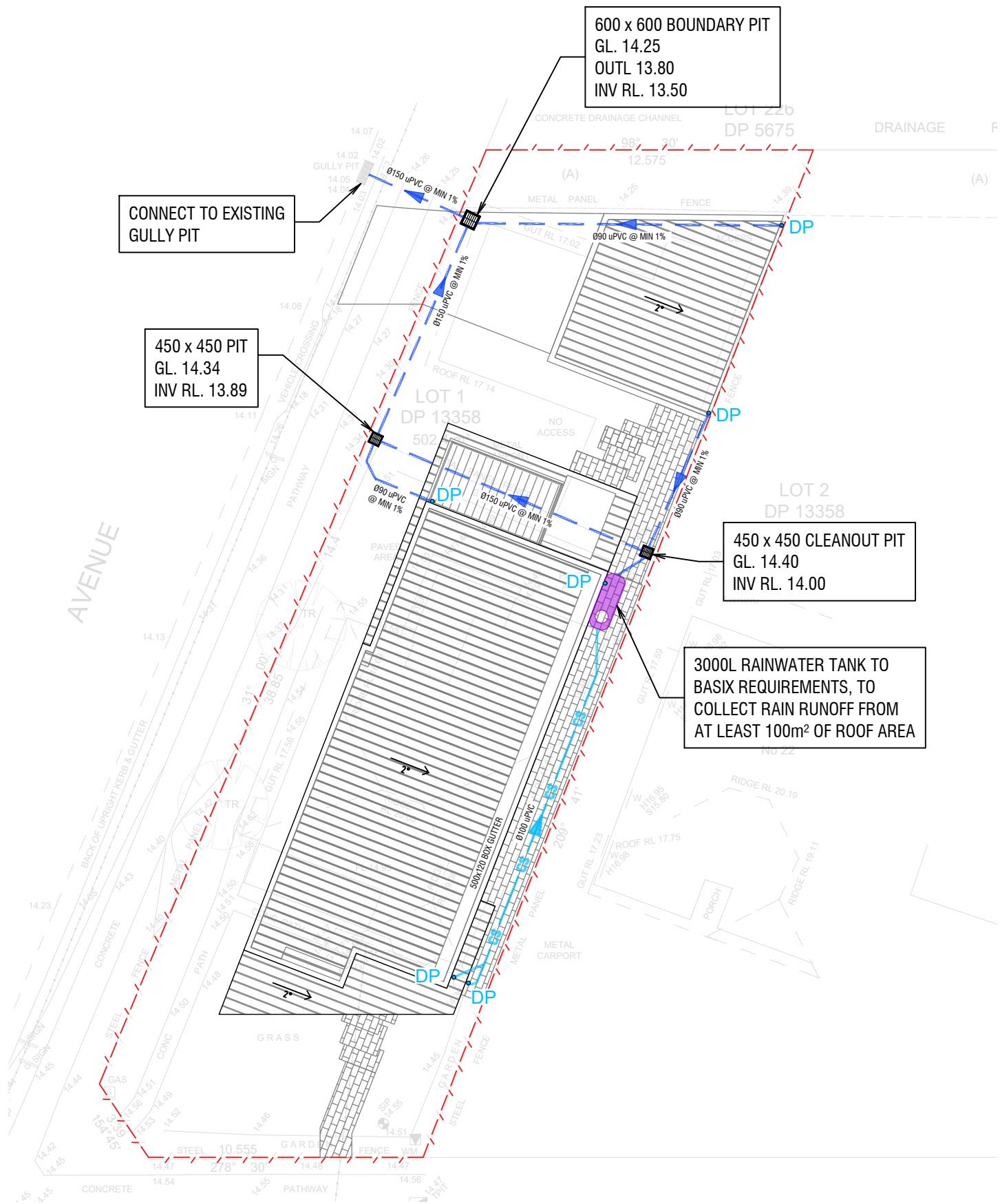
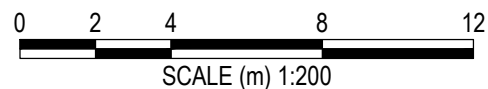

## STORMWATER DRAINAGE PLAN

SCALE 1:200

### DRAWINGS TO BE PRINTED IN COLOUR

| REV | DATE       | AMENDMENT / REVISION DESCRIPTION | TITLE        | NAME |
|-----|------------|----------------------------------|--------------|------|
| A   | 10/12/2024 | ISSUED FOR DA - STORMWATER       | DRAWN        | JP   |
| B   | 06/06/2025 | ISSUED FOR DA                    | DESIGNED     | JP   |
|     |            |                                  | DRG CHECK    | PH   |
|     |            |                                  | DESIGN CHECK | PH   |
|     |            |                                  | APPROVED     | PH   |

IF IN DOUBT, ASK

HYVE DESIGNS



ISSUED FOR DA

|   |              |                    |                  |          |
|---|--------------|--------------------|------------------|----------|
| SITE ADDRESS<br>23 CHELMSFORD AVE, BANKSTOWN  |              |                    |                  |          |
| CLIENT<br>MINH TRAN   |              |                    |                  |          |
| STORMWATER DRAINAGE PLAN  |              |                    |                  |          |
| THIS DRAWING AND THE INFORMATION CONTAINED THEREON HAVE BEEN CREATED SOLELY FOR A PARTICULAR PURPOSE AND CLIENT. THIS IS PROTECTED BY COPYRIGHT. YOU MAY NOT REPRODUCE ANY OF IT IN ANY FORM WITHOUT THE WRITTEN PERMISSION BY HYVE DESIGNS PTY LTD. IF YOU DO, YOU MAY HAVE TO PAY FOR DAMAGES TO HYVE DESIGNS PTY LTD OR YOU MAY BE PROSECUTED. |              |                    |                  |          |
| JOB NUMBER:<br>24217  | DATUM<br>AHD | SCALE<br>A3, 1:200 | SHEET No<br>SW01 | REV<br>B |

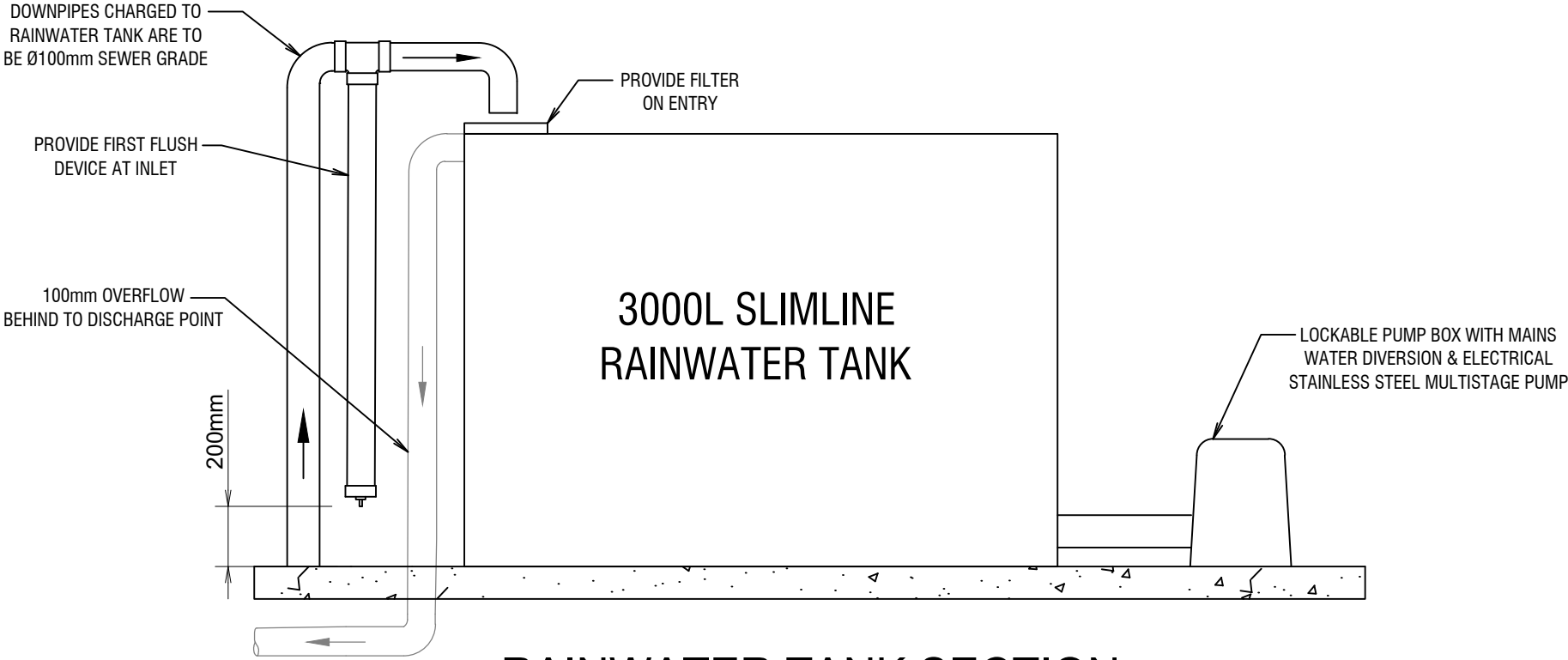

**RAINWATER TANK SECTION**  
SCALE: NTS

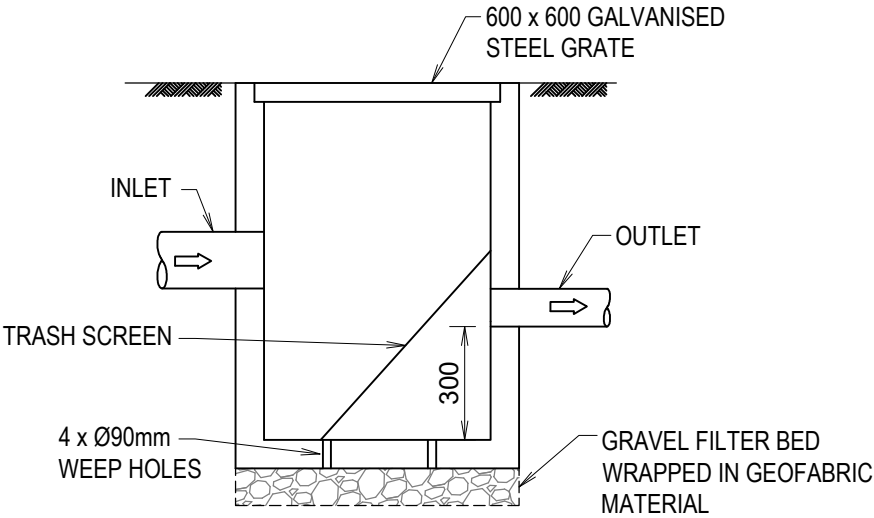

**BOUNDARY PIT**  
SCALE: NTS

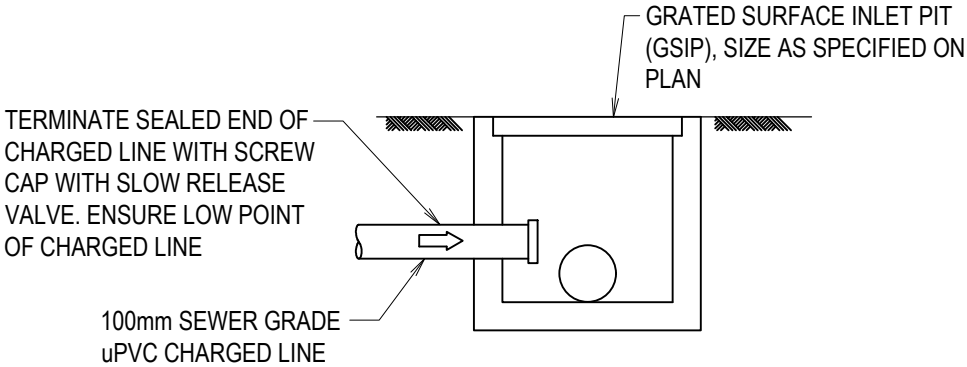

**CHARGED LINE CLEANOUT PIT DETAIL**  
SCALE: NTS

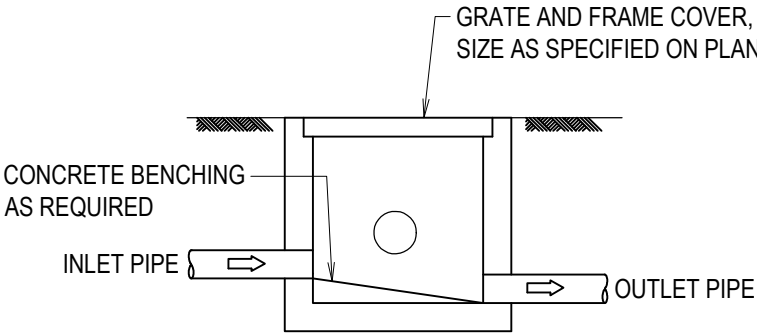

**TYPICAL PIT**  
SCALE: NTS

ISSUED FOR DA

DRAWINGS TO BE PRINTED IN COLOUR

IF IN DOUBT, ASK

| REV | DATE       | AMENDMENT / REVISION DESCRIPTION | TITLE        | NAME |
|-----|------------|----------------------------------|--------------|------|
| A   | 10/12/2024 | ISSUED FOR DA - STORMWATER       | DRAWN        | JP   |
| B   | 06/06/2025 | ISSUED FOR DA                    | DESIGNED     | JP   |
|     |            |                                  | DRG CHECK    | PH   |
|     |            |                                  | DESIGN CHECK | PH   |
|     |            |                                  | APPROVED     | PH   |



|   |              |                  |                  |          |
|---|--------------|------------------|------------------|----------|
| SITE ADDRESS<br>23 CHELMSFORD AVE, BANKSTOWN  |              |                  |                  |          |
| CLIENT<br>MINH TRAN   |              |                  |                  |          |
| STORMWATER DETAILS  |              |                  |                  |          |
| THIS DRAWING AND THE INFORMATION CONTAINED THEREON HAVE BEEN CREATED SOLELY FOR A PARTICULAR PURPOSE AND CLIENT. THIS IS PROTECTED BY COPYRIGHT. YOU MAY NOT REPRODUCE ANY OF IT IN ANY FORM WITHOUT THE WRITTEN PERMISSION BY HYVE DESIGNS PTY LTD. IF YOU DO, YOU MAY HAVE TO PAY FOR DAMAGES TO HYVE DESIGNS PTY LTD OR YOU MAY BE PROSECUTED. |              |                  |                  |          |
| JOB NUMBER:<br>24217  | DATUM<br>AHD | SCALE<br>A3, NTS | SHEET No<br>SW02 | REV<br>B |



### LEGEND PROPOSED

- BOUNDARY LINE
- SEDIMENT FENCE
- SITE FENCE
- MESH INLET FILTER
- GEOTEXTILE INLET
- STOCKPILE
- STABILISED SITE ACCESS

# SEDIMENT & EROSION CONTROL PLAN

SCALE 1:200

- NOTES:
- THE SITE SUPERINTENDENT/ENGINEER WILL ENSURE THAT ALL SOIL AND WATER MANAGEMENT WORKS ARE LOCATED AS DOCUMENTED.
  - ALL WORK SHALL BE GENERALLY CARRIED OUT IN ACCORDANCE WITH
    - LOCAL AUTHORITY REQUIREMENT
    - EPA REQUIREMENTS
    - NSW DEPARTMENT OF HOUSING MANUAL "MANAGING URBAN STORMWATER, SOILS AND CONSTRUCTION", 4th EDITION, MARCH 2004.
    - LANDCOM'S MANAGING URBAN STORMWATER - SOIL AND CONSTRUCTION 'THE BLUE BOOK' LATEST EDITION.
  - MAINTAIN THE EROSION CONTROL DEVICES TO THE SATISFACTION OF THE SUPERINTENDENT AND THE LOCAL AUTHORITY.
  - CONTRACTOR IS TO ENSURE ALL EROSION & SEDIMENT CONTROL DEVICES ARE MAINTAINED IN GOOD WORKING ORDER AND OPERATE EFFECTIVELY. REPAIRS AND OR MAINTENANCE SHALL BE UNDERTAKEN AS REQUIRED, PARTICULARLY FOLLOWING STORM EVENTS.
  - WATER WILL BE PREVENTED FROM ENTERING THE PERMANENT DRAINAGE SYSTEM UNLESS IT IS RELATIVELY SEDIMENT FREE, I.E. THE CATCHMENT AREA HAS BEEN PERMANENTLY LANDSCAPED AND/OR ANY LIKELY SEDIMENT HAS BEEN FILTERED THROUGH AN APPROVED STRUCTURE.
  - TEMPORARY SOIL AND WATER MANAGEMENT STRUCTURES WILL BE REMOVED ONLY AFTER THE LANDS THEY ARE PROTECTING ARE REHABILITATED.
  - AFTER RAIN, INSPECT, CLEAN, AND REPAIR IF REQUIRED, TEMPORARY EROSION & SEDIMENT CONTROL MEASURES.
  - THE EROSION & SEDIMENT CONTROL PLAN PROVIDED IS ONLY INDICATIVE. THE CONTRACTOR SHOULD PREPARE A DETAILED ESCP SUITABLE FOR THE SPECIFIC SITE CONDITIONS
  - ALL WORK IS TO BE CARRIED OUT TO PREVENT EROSION, CONTAMINATION & SEDIMENTATION OF THE STORAGE SITE, SURROUNDING AREAS & DRAINAGE SYSTEMS.
  - MINIMISE DISTURBED AREA COVERED WITH NATURAL VEGETATION. ONLY THOSE AREAS DIRECTLY REQUIRED FOR CONSTRUCTION ARE TO BE DISTURBED.
  - INSTALL EROSION/SEDIMENT CONTROL MEASURES PRIOR TO COMMENCEMENT OF CONSTRUCTION OR EXCAVATION OPERATIONS.
  - DO NOT STOCKPILE EXCAVATED MATERIAL ON THE ROAD WAY.
  - DIVERT CLEAN WATER FROM UNDISTURBED AREAS AROUND THE WORKING AREAS.
  - CONSTRUCTION ENTRY/EXIT SHALL BE VIA THE LOCATION NOTED ON THE DRAWING. CONTRACTOR SHALL ENSURE ALL DROPPABLE SOIL & SEDIMENT IS REMOVED PRIOR TO CONSTRUCTION TRAFFIC EXITING SITE. CONTRACTOR SHALL ENSURE ALL CONSTRUCTION TRAFFIC ENTERING AND LEAVING THE SITE DO SO IN A FORWARD DIRECTION.

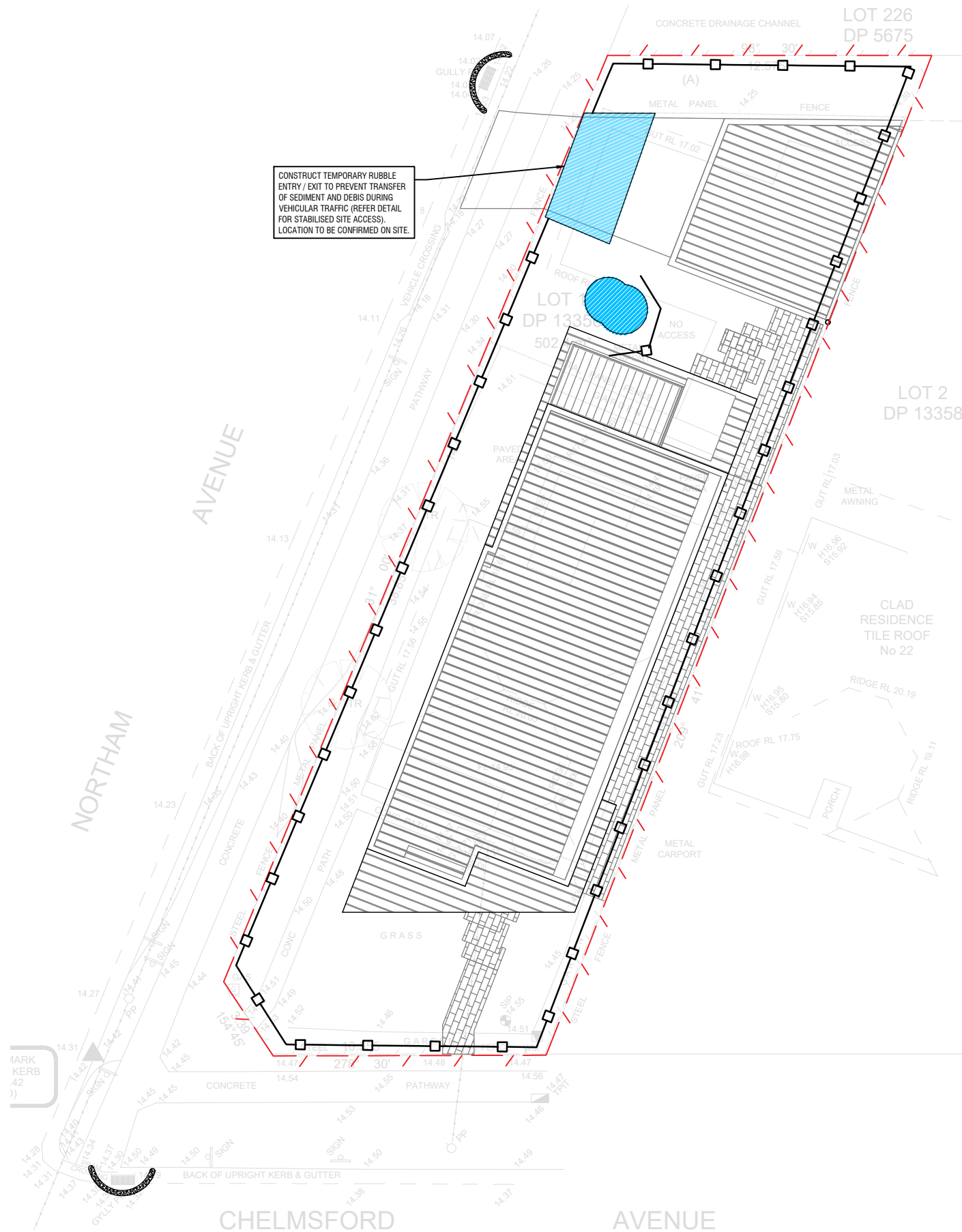
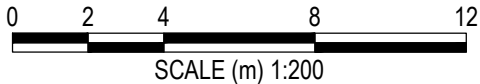

### DRAWINGS TO BE PRINTED IN COLOUR

| REV | DATE       | AMENDMENT / REVISION DESCRIPTION | TITLE        | NAME |
|-----|------------|----------------------------------|--------------|------|
| A   | 10/12/2024 | ISSUED FOR DA - STORMWATER       | DRAWN        | JP   |
| B   | 06/06/2025 | ISSUED FOR DA                    | DESIGNED     | JP   |
|     |            |                                  | DRG CHECK    | PH   |
|     |            |                                  | DESIGN CHECK | PH   |
|     |            |                                  | APPROVED     | PH   |

IF IN DOUBT, ASK

**HYVE DESIGNS**

ISSUED FOR DA

SITE ADDRESS  
23 CHELMSFORD AVE, BANKSTOWN

CLIENT  
MINH TRAN

### SEDIMENT & EROSION CONTROL PLAN

THIS DRAWING AND THE INFORMATION CONTAINED THEREON HAVE BEEN CREATED SOLELY FOR A PARTICULAR PURPOSE AND CLIENT. THIS IS PROTECTED BY COPYRIGHT. YOU MAY NOT REPRODUCE ANY OF IT IN ANY FORM WITHOUT THE WRITTEN PERMISSION BY HYVE DESIGNS PTY LTD. IF YOU DO, YOU MAY HAVE TO PAY FOR DAMAGES TO HYVE DESIGNS PTY LTD OR YOU MAY BE PROSECUTED.

| JOB NUMBER: | DATUM | SCALE     | SHEET No | REV |
|-------------|-------|-----------|----------|-----|
| 24217       | AHD   | A3, 1:200 | SE01     | B   |



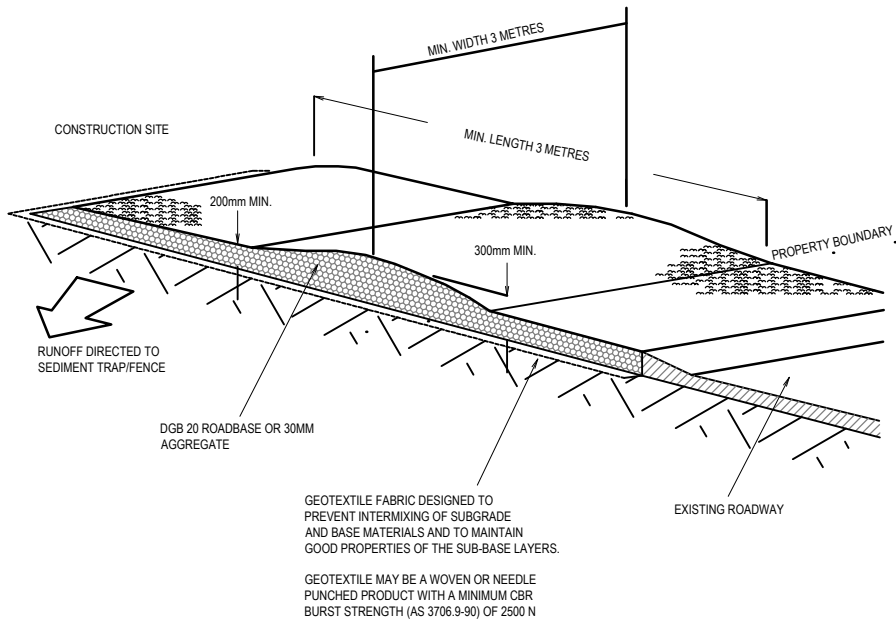

- CONSTRUCTION NOTES
1. STRIP TOPSOIL AND LEVEL SITE
  2. COMPACT SUBGRADE.
  3. COVER AREA WITH NEEDLE-PUNCHED GEOTEXTILE.
  4. CONSTRUCT 200mm THICK PAD OVER GEOTEXTILE USING ROADBASE OR 30MM AGGREGATE. MINIMUM LENGTH 15m OR TO BUILDING ALIGNMENT. MINIMUM WIDTH 3 METRES.
  5. CONSTRUCT HUMP IMMEDIATELY WITHIN BOUNDARY TO DIVERT WATER TO A SEDIMENT FENCE OR OTHER SEDIMENT TRAP.

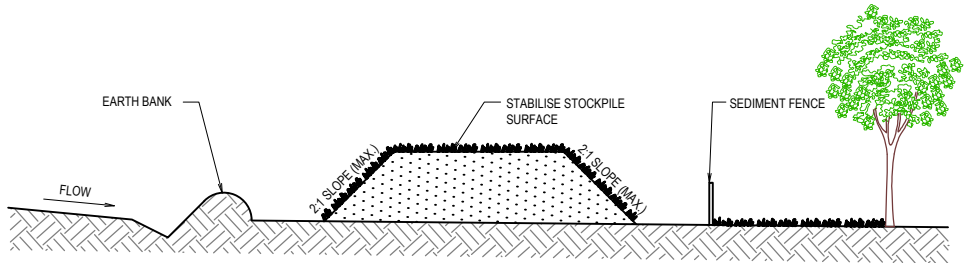

- CONSTRUCTION NOTES:
1. PLACE STOCKPILES MORE THAN 2 (PREFERABLY 5) METRES FROM EXISTING VEGETATION, CONCENTRATED WATER FLOW, ROADS AND HAZARD AREAS.
  2. CONSTRUCT ON THE CONTOUR AS LOW, FLAT, ELONGATED MOUNDS
  3. WHERE THERE IS SUFFICIENT AREA, TOPSOIL STOCKPILES SHALL BE LESS THAN 2m IN HEIGHT
  4. WHERE THERE ARE TO BE IN PLACE FOR MORE THAN 10 DAYS, STABILISE FOLLOWING THE APPROVED ESCP OR SWMP TO REDUCE THE C-FACTOR TO LESS THAN 0.10
  5. CONSTRUCT EARTH BANKS (STANDARD DRAWING 5-5) ON THE UPSLOPE SIDE TO DIVERT WATER AROUND STOCKPILES AND SEDIMENT FENCES (STANDARD DRAWING 6-8) 1m TO 2m DOWNSLOPE

### STOCKPILES

N.T.S.

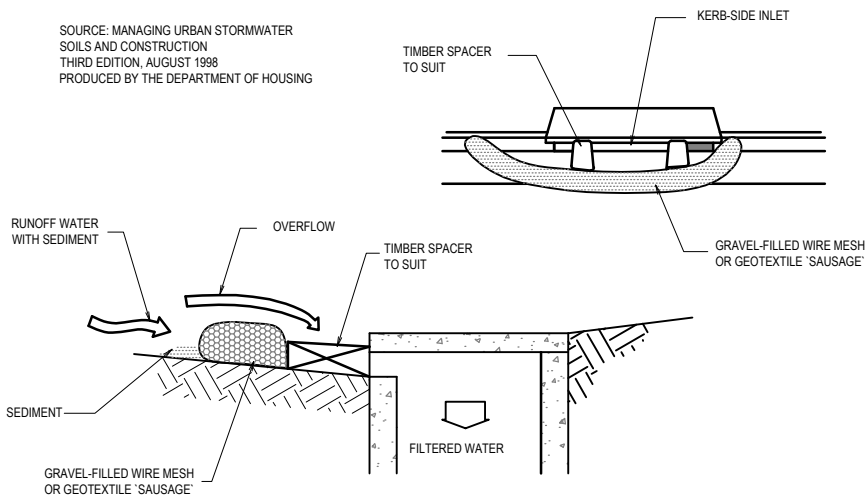

NOTE: THIS PRACTICE ONLY TO BE USED WHERE SPECIFIED IN AN APPROVED SWMP/ESCP.

- CONSTRUCTION NOTES
1. FABRICATE A SLEEVE MADE FROM GEOTEXTILE OR WIRE MESH LONGER THAN THE LENGTH OF THE INLET PIT.
  2. FILL THE SLEEVE WITH 25mm TO 50mm GRAVEL.
  3. FORM AN ELLIPTICAL CROSS-SECTION ABOUT 150mm HIGH X 400mm WIDE.
  4. PLACE THE FILTER AT THE OPENING OF THE KERB INLET LEAVING A 100mm GAP AT THE TOP TO ACT AS AN EMERGENCY SPILLWAY.
  5. MAINTAIN THE OPENING WITH SPACER BLOCKS.
  6. FORM A SEAL WITH THE KERBING AND PREVENT SEDIMENT BYPASSING THE FILTER.
  7. FIT TO ALL KERB INLETS AT SAG POINTS.

### MESH AND GRAVEL INLET FILTER

N.T.S.

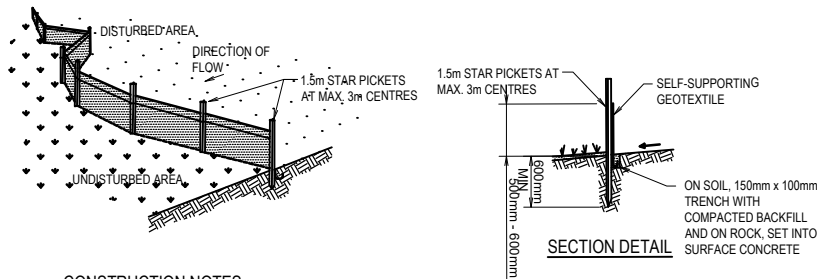

- CONSTRUCTION NOTES
1. CONSTRUCT SEDIMENT FENCE AS CLOSE AS POSSIBLE TO PARALLEL TO THE CONTOURS OF THE SITE.
  2. DRIVE 1.5m LONG STAR PICKETS INTO GROUND, 3 METERS APART.
  3. DIG A 150mm DEEP TRENCH ALONG THE UPSLOPE LINE OF THE FENCE FOR THE BOTTOM OF THE FABRIC TO BE ENTRENCHED.
  4. BACKFILL TRENCH OVER BASE OF FABRIC.
  5. FIX SELF-SUPPORTING GEOTEXTILE TO UPSLOPE SIDE OF POSTS WITH WIRE TIES OR AS RECOMMENDED BY GEOTEXTILE MANUFACTURER.
  6. JOIN SECTIONS OF FABRIC AT A SUPPORT POST WITH A 150mm OVERLAP.

### SEDIMENT CONTROL FENCE

N.T.S.

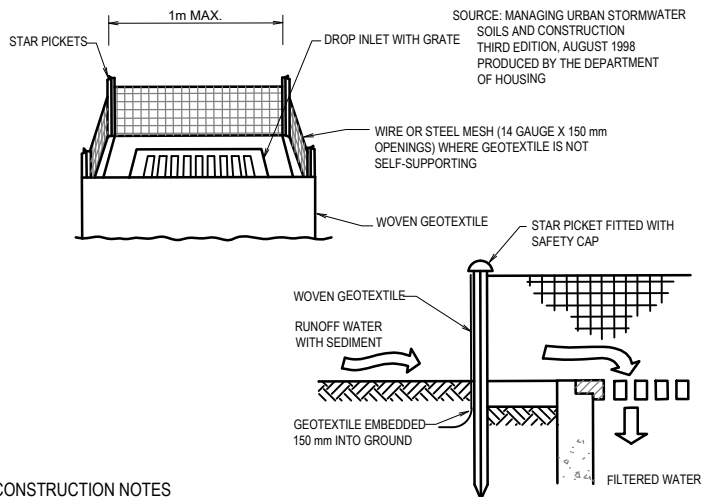

- CONSTRUCTION NOTES
1. FABRICATE A SEDIMENT BARRIER FROM GEOTEXTILE OR STRAW BALES.
  2. SUPPORT GEOTEXTILE WITH MESH TIED TO POSTS AT 1 METER CENTRES.
  3. DO NOT COVER INLET WITH GEOTEXTILE.
  4. CONSTRUCTION DETAILS ARE SIMILAR TO TYPICAL SEDIMENT FENCING DETAIL.

### GEOTEXTILE INLET FILTER

N.T.S.

ISSUED FOR DA

### DRAWINGS TO BE PRINTED IN COLOUR

| REV | DATE       | AMENDMENT / REVISION DESCRIPTION | TITLE        | NAME |
|-----|------------|----------------------------------|--------------|------|
| A   | 10/12/2024 | ISSUED FOR DA - STORMWATER       | DRAWN        | JP   |
| B   | 06/06/2025 | ISSUED FOR DA                    | DESIGNED     | JP   |
|     |            |                                  | DRG CHECK    | PH   |
|     |            |                                  | DESIGN CHECK | PH   |
|     |            |                                  | APPROVED     | PH   |

IF IN DOUBT, ASK

HYVE DESIGNS

SITE ADDRESS  
23 CHELMSFORD AVE, BANKSTOWN

CLIENT  
MINH TRAN

### SEDIMENT & EROSION DETAILS

THIS DRAWING AND THE INFORMATION CONTAINED THEREON HAVE BEEN CREATED SOLELY FOR A PARTICULAR PURPOSE AND CLIENT. THIS IS PROTECTED BY COPYRIGHT. YOU MAY NOT REPRODUCE ANY OF IT IN ANY FORM WITHOUT THE WRITTEN PERMISSION BY HYVE DESIGNS PTY LTD. IF YOU DO, YOU MAY HAVE TO PAY FOR DAMAGES TO HYVE DESIGNS PTY LTD OR YOU MAY BE PROSECUTED.

| JOB NUMBER: | DATUM | SCALE   | SHEET No | REV |
|-------------|-------|---------|----------|-----|
| 24217       | AHD   | A3, NTS | SE02     | B   |